

# PLUS LOCATION SOFTWARE

The Time Domain Location Software is the software component of a PLUS Real-Time Location System (RTLS) and delivers highly accurate and reliable position information on PLUS tags using a Time Difference of Arrival (TDOA) technique. The Location Software processes tag information in the form of TOA packets from the PLUS UWB sensor network and computes precision X and Y locations to pass through its API for higher layer application software.

The Location Software also includes the Visualizer installation/maintenance software tool, which is used in the initial setup, configuration, and calibration of the PLUS reader network. The Visualizer provides graphical tools to display reader layout and tag positions in real-time, as well as other tools and statistics to verify overall PLUS system performance.

## BENEFITS

- Supports multiple RTLS modes including 0D (reader proximity mode), 1D (precision location along a line), 2D (precision X,Y location), and 2.5D (precision X,Y location and floor/zone)
- Runs as OCX or Service on Windows XP/Vista
- Runs as Service on Linux (Red Hat or Ubuntu)
- Includes Visualizer installation/maintenance software utility
- Intuitive API for quick integration with software applications
- Supports decimation of tag data to reduce processing load on software applications
- Easily imports floor plans for quick display of coverage zones
- Allows 2-tag association to a single person or asset
- Supports 2D tracking using multiple SDPs
- Provides system health diagnostics that push reader network status/alerts

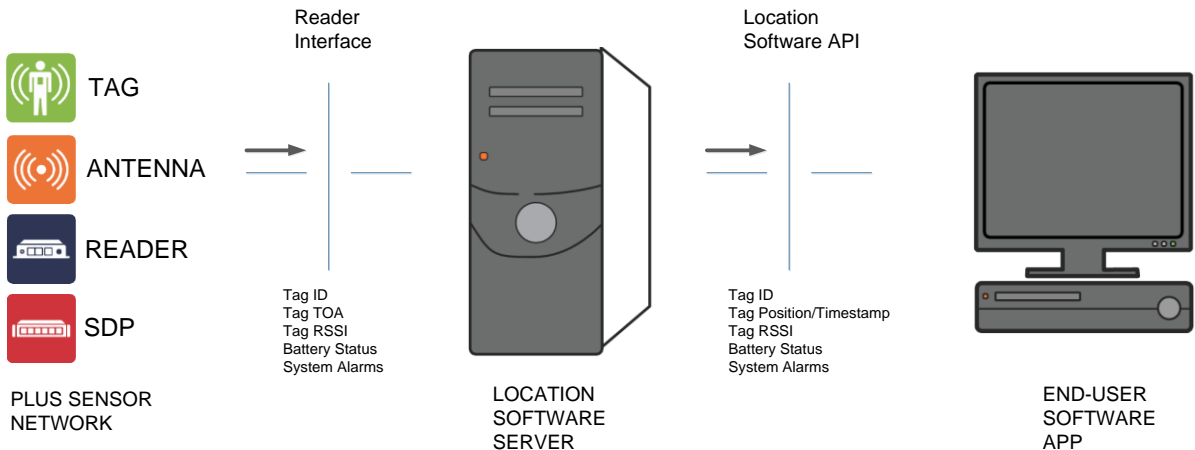

## FLEXIBILITY IN CONFIGURATION OF RTLS MODES

- 0D** Zone location of a tag across a large coverage area (tens of thousands of square feet) using very few readers
- 1D** Assembly line/Hallway precision location of a tag along a line in one dimension
- 2D** Precision X,Y location of a tag in a defined coverage area
- 2.5D** Precision X,Y location of a tag with an additional floor or zone designation

## TAG CAPACITY

The PLUS Location Software can reliably compute thousands of tag positions per second in any of the four RTLS modes (0D, 1D, 2D, 2.5D) with a single installation. However, if additional tag capacity is required then a faster (relative to the recommended hardware platform) hardware platform/CPU can be utilized or another instance of the Location Software can be installed on a second server.

## HARDWARE AND SOFTWARE REQUIREMENTS

### PLUS VISUALIZER

Windows XP, Vista, Windows 7

### LOCATION ENGINE (OCX)

Windows XP, Vista, Windows 7

### LOCATION ENGINE SERVICE

Windows XP, Vista, Windows 7,  
Linux (Ubuntu or Red Hat)

### SERVER HARDWARE

Intel Quad Core 2.4 GHz Processor  
3 GB RAM

## ORDERING INFORMATION

### PLUS LOCATION SOFTWARE (ALL REGIONS)

Part Number 2000S01

### MAINTENANCE

2 Year Updates and Support  
Part Number 2011S01

## FOR MORE INFORMATION



Cummings Research Park  
4955 Corporate Dr. Suite 101  
Huntsville, Alabama 35805

1.256.217.4072 phone  
1.256.217.4775 fax  
[www.plus-ls.com](http://www.plus-ls.com)